

CSI UNDERGRADUATE CONFERENCE

RESEARCH, SCHOLARSHIP, AND THE ARTS



THURSDAY, MAY 1, 2025

www.csi.cuny.edu/ugconference



College of Staten Island
The City University of New York



Sponsored by
the Division of
Academic Affairs with
special thanks to our
campus partners who
supported this
conference: CSI Alumni Association.

THE CITY UNIVERSITY
OF NEW YORK
**College of
Staten Island**

ALUMNI

Message from the President



Undergraduate research is one of the hallmarks of a top-tier institution, and the College of Staten Island can truly claim a legacy of this activity. Our faculty work with and involve students in an impressive array of high-impact practices, providing meaningful exposure to research in the sciences, humanities, business, education, and performing and creative arts, as well as the social and health sciences. What you see before you is the culmination of hundreds of hours of activity in laboratories, archives, and elsewhere. The dedication of our faculty in supporting these efforts is matched only by the enthusiasm and talented contributions of their student counterparts.

The activities you see on display at this event are proof that hands-on, experiential learning is key to a college curriculum. Through undergraduate research, our students are able to apply the theories, concepts, and constructs they learned about in lecture to the real world. The linkage of theoretical and applied knowledge is a crucial component of undergraduate education and represents the very best of both teaching and learning.

The annual Undergraduate Research Conference is one of the proudest days for the College of Staten Island. It allows us to celebrate the accomplishments of so many students in so many disparate areas; I am pleased to share with you all the hard work of our students and their faculty mentors. Enjoy the event!

Sincerely,

A handwritten signature in black ink that reads "Timothy G. Lynch". The signature is fluid and cursive, with the first name "Timothy" being more prominent and stylized.

Timothy G. Lynch, Ph.D. (*he/him/his*)
President

CSI Undergraduate Conference on Research, Scholarship, and the Arts
Thursday, May 1, 2025

11:00- Noon	Student Check-in
Noon-1:00pm	Lunch available to participating students and mentors 1P-116 (pick up)
1:00pm-2:00pm	Plenary Session Williamson Theatre, 1P-111 Musical Introduction Angel Muñoz-Avila (Class of '25), Harpist Welcome and Introductions Laxmi Ramasubramanian - Associate Provost Opening Remarks Michael E. Steiper - Provost/Senior Vice President for Academic Affairs Keynote Address Rosanne Carlo- Associate Professor of English <i>Leading a Curious Life: Research as a Hunt for What We Don't Know (Yet)</i> Sharon Loverde- Professor of Chemistry <i>Zooming into the Nucleosome Core Particle with a Computational Microscope</i> Remarks from Sponsors Closing Musical Performance Angel Muñoz-Avila (Class of '25), Harpist
2:00pm-4:00pm	Poster Presentations 1P Atrium
2:30pm-4:00pm	Lab Theater - Performing and Creative Arts - Drama Program Lab Theatre, 1P-110B Excerpts from the PCA production of Shakespeare's comedy <i>Twelfth Night</i> , directed by Lee Papa of the Department of English. Emma Ferguson, Gary Fleming, Cassandra Perera, Nelie Ramos, Regan Sou, Teddy Wells, & Robert Yost
2:30pm-4:30pm	Exhibitions - The Student Art Gallery 1P-118B A Juried Group Exhibition of Student Art Curated by PCA student curators: Janinne Aguayza-Calle and Cassian Feliciano. Faculty advisors: Assistant Professor Beth Livensperger & Associate Professor Chris Verene
2:30pm-3:30pm	Unveiled Process: Installing Art in the Gallery 1P-122 We welcome visitors to experience the creative process in action! While installing, the gallery will remain open during the URC, allowing guests to witness the transformation of the space as artworks take shape. This unique opportunity provides insight into the behind-the-scenes work of curators and artists. While some areas may be in progress, we invite you to explore, ask questions to the BFA candidates about their works, and get a sneak peek at the upcoming exhibition. Participating artists: Ifesinachi Anosike, Ivanna Beliaieva, Nando Brunetti, Axel Delgado, Ivan Estevez, Jamie Yescas, Alan Guzman, Madison Malerba, Victoria Paradiso, Emily Wu

CSI Undergraduate Conference on Research, Scholarship, and the Arts

Thursday, May 1, 2025

2:30pm-3:00pm Electronic Music Festival

Williamson Theatre, 1P-111

Students explore the intersection of technology, music composition, and the creative possibilities offered by computer-based tools and techniques in live performance.

2:30pm-4:30pm Film Screenings and Posters - Media Culture

1P-223

Films, videos, and posters (representing advanced design and digital media) presented by students from the Department of Media Culture.

3:00pm-4:00pm Music Hour - Performing and Creative Arts - Music Program

Williamson Theatre, 1P-111

Performances featuring the Young Artists and the chamber music students of the CSI Music Program. Featuring Robert Lombardi, Aniya Pearson, Malcolm Melendez, Maksim Nam, Genevieve Steinmetz, Anthony Gavin, Angel Muñoz-Avila, Timothy Golubowski, Aaron Hernandez, & Nabeel Deen

Poster Floor Plan

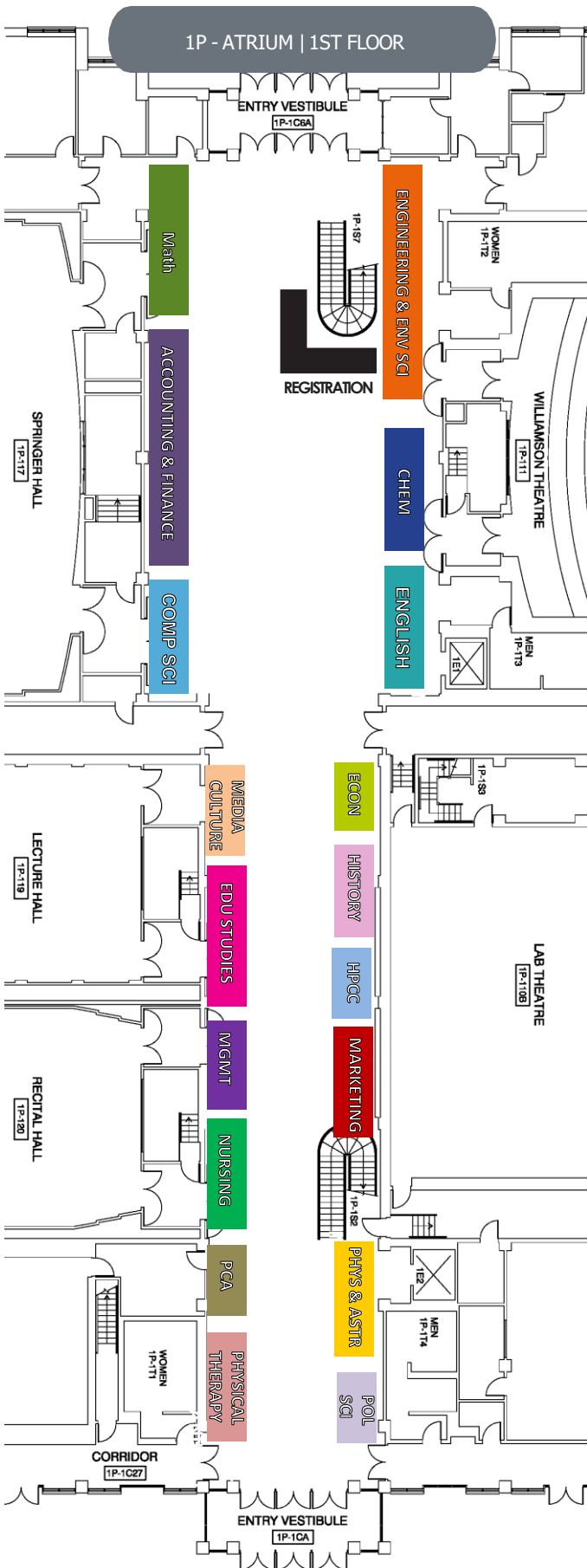

ACCOUNTING & FINANCE 1st Floor - Front Entrance South Wall (Springer Hall)
BIOLOGY 2nd Floor – West Lounge and Walkway
CHEMISTRY 1st Floor - Front Entrance North Wall (Williamson Theater)
COMPUTER SCIENCE 1st Floor - Front Entrance South Wall (Springer Hall)
ECONOMICS 1st Floor - Center - North Wall (Lab Theater)
EDUCATIONAL STUDIES 1st Floor – Center South Wall (Lecture/Recital Halls)
ENGLISH 1st Floor - Front Entrance North Wall (Williamson Theater)
ENGINEERING & ENV. SCI 1st Floor - Front Entrance North Wall (Williamson Theater)
HISTORY 1st Floor - Center - North Wall (Lab Theater)
HPCC 1st Floor - Center - North Wall (Lab Theater)
MANAGEMENT 1st Floor – Center South Wall (Lecture/Recital Halls)
MARKETING 1st Floor - Center - North Wall (Lab Theater)
MATHEMATICS 1st Floor - Front Entrance South Wall (Springer Hall)
Media Culture 1st Floor – Center South Wall (Lecture Halls)
NURSING 1st Floor – Center South Wall (Recital Halls)
PCA 1st Floor - Back Entrance - South Wall
PHYSICS & ASTRONOMY 1st Floor - Back Entrance - North Wall
PHYSICAL THERAPY 1st Floor - Back Entrance - South Wall
POLITICAL SCIENCE & GLOBAL AFFAIRS 1st Floor - Back Entrance - North Wall
PSYCHOLOGY 2nd Floor – East Lounge

Poster Floor Plan

1P - 2ND FLOOR - WEST LOUNGE

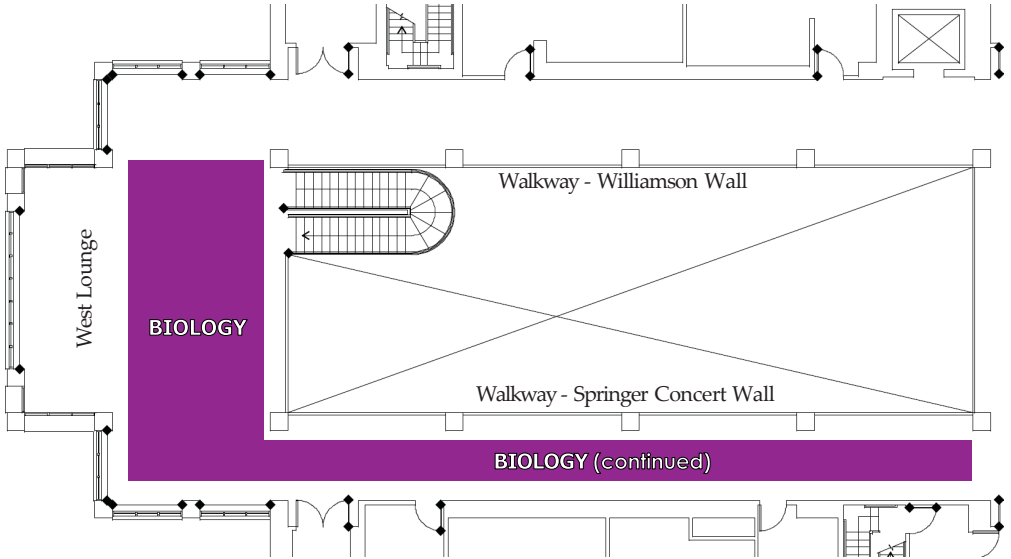

1P - 2ND FLOOR - EAST LOUNGE

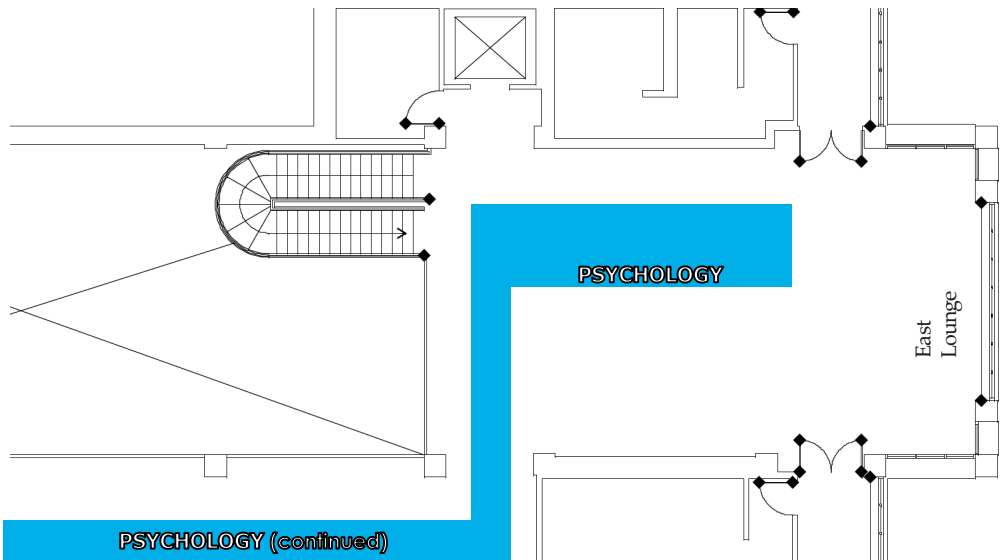



POSTER PRESENTATIONS

Center for the Arts
2:00pm-4:00pm

ACCOUNTING AND FINANCE

ACC/FNC-01

Assessing the Possibility and Impact of a High-Speed Rail Network Connecting New York City and Toronto

Christopher Vitale

Faculty Mentor: Professor Jonathan Peters

ACC/FNC-02

Risk Mitigation and Diversification for NYC transit system

Tal Ohana

Faculty Mentor: Professor Jonathan Peters

ACC/FNC-03

Factors In Major League Baseball Team Valuations

Joseph Sollitto

Faculty Mentor: Professor Jonathan Peters

ACC/FNC-04

The Impact of AI on Financial Auditing

Jennifer Tuzzo

Faculty Mentor: Professor Patricia Galletta

ACC/FNC-05

How Will the Trump Administration’s 2025 Tax Policies Impact the Economy, Businesses, and Income Distribution?

Fatima Perera

Faculty Mentor: Professor Patricia Galletta

ACC/FNC-06

The Impact of Artificial Intelligence on the Accounting Profession

Huli Yu

Faculty Mentor: Professor Banu Aslanertik

ACC/FNC-07

Transportation and Infrastructure Improvements in Staten Island North Shore’s Economic Redevelopment

Adrian Rosales

Faculty Mentor: Professor Jonathan Peters

BIOLOGY

BIO-01

The Effects of Recreational and Pharmaceutical Substance Use on Oral Microbiomes and Health

Julia Kalinowski

Faculty Mentor: Professor Michelle Esposito

BIO-02

Analysis of EGFR/RAS Isoforms in Melanoma and Effects of PKI-166 on EGFR

Abedalfattah Twam

Faculty Mentor: Professor Nancy Liu-Sullivan

BIO-03**Measuring Atrophy and Fiber-type Alteration in Mice Following Spinal Cord Injury**

Jessica Poplawski

Faculty Mentor: Professor Jean-Phillippe Berteau

BIO-04**A Meta Analysis of TME Founder Genes in Glioblastoma Multiforme (GBM), Low-Grade Glioma (LGG) and Melanoma**

Melina Turco, Ambar Alvarenga

Faculty Mentor: Professor Nancy Liu-Sullivan

BIO-05**The Influence Of The Gut Microbiome On Anxiety And The Treatment Outcomes Through The Gut-brain Axis**

Sue-Allen Mettry

Faculty Mentor: Professor Faiza Peetz

BIO-06**The Impacts of Cyanobacteria on the Mammalian Microbiome**

Richard Verdi Jr.

Faculty Mentor: Professor Aris Efting

BIO-07**Exploring The Microbiome-Gut-Brain Axis, Neurophysiology And Inflammation In Neurodegenerative Diseases And Tau(Alzheimer's Disease)**

Mir Rhaman

Faculty Mentor: Professor Faiza Peetz

BIO-08**Exploring the Gut-Brain Axis and Microbiota In Human Physiology: A Spotlight on Pharmaceutical Intervention**

Julia Palka

Faculty Mentor: Professor Faiza Peetz

BIO-09**Exploring the Microbiome-Gut-Brain Axis in Cardiovascular Disease**

Marcelina Rokicki

Faculty Mentor: Professor Faiza Peetz

BIO-10**Exploring The Role Of Collagen Genes In Head/Neck Cancer Tumor Microenvironment**

Santos Hana, Samer Hana, David Akodu, Haneen Makii, Jacob Lebedinsky, Aisha Yousaf, Sarah Lebaili,

Faculty Mentor: Professor Nancy Liu-Sullivan

BIO-11**Review of the Dual Impact of Gut Microbiota: Unraveling its Role in the Pathogenesis and Treatment of Inflammatory Bowel Disease**

Luciano Spagnuolo, Ethan Hoy

Faculty Mentor: Muhammad Zia

BIO-12

The Gut Microbiome's Influence on Cancer Progression and Treatment Outcomes Through the Gut-Brain Axis

Menatalla Aboukhalia

Faculty Mentor: Faiza Peetz

BIO-14

The Gut-Brain Axis And Alzheimer's Disease: Exploring The Role Of The Gut Microbiome In Neurodegeneration

Branny De Jesus Santana

Faculty Mentor: Professor Faiza Peetz

BIO-15

Microbiome-Gut-Brain Axis, Immune Dynamics, and Neurological Well-Being

Joey Yu

Faculty Mentor: Professor Lisa Manne

BIO-16

Characterizing The Role Of Collagen Genes In Breast Cancer Tumor Microenvironment

Ilyana Mukabenova, Hiqmat Ogunsanya,

Faculty Mentor: Professor Nancy Liu-Sullivan

BIO-17

The Relationship Between Neuropsychiatric Disorders and the Oral Microbiome

Mariam Ayed, Julia Kalinowski, Ahsan Tasneem

Faculty Mentor: Professor Esposito Michelle

BIO-18

Cohort-Based Analysis of Vodka's Epigenetic and Behavioral Influence on Tenebrio Molitor

Nourhan Elzayat

Faculty Mentor: Professor Aris Efting

BIO-19

Drivers Of Individual - Species Diversity Relationship

Morgan Novello

Faculty Mentor: Professor Lisa Manne

BIO-20

Regulation of Clustered Protocadherin-Mediated Adhesion: Insights from Junction Length and Continuity Analysis

Lauren Ferguson

Faculty Mentor: Professor Greg Phillips

BIO-21

Age-Dependent Movement Patterns in Lesser Black-Backed Gulls: The Influence of Maturation and Experience

Brian Kerliu

Faculty Mentor: Professor Lisa Manne

BIO-22

Lotus Stems As Scaffolds For 3D Cell Culture and Bioengineering

Bora Kupa

Faculty Mentor: Professor Krishnaswami Raja

BIO-23**Leveraging ATAC-seq and PRO-seq to Identify TREs that Control the Expression of Cyclin D**

Jawuneh Danmbisaa

Faculty Mentor: Professor Cesar Arenas-Mena

BIO-24**Psychological Distress among Hispanics with Diabetes in New York City**

Poornima Ilangachcharige, Miguel Andrei Padilla, Shane Desilva

Faculty Mentor: Professor Shiryn Sukhram

BIO-25**Impact of Climate Change on Malaria Transmission in Sub-Saharan Africa**

Malak Alkisiwani

Faculty Mentor: Professor Aris Efting

BIO-26**The Effect of ARBs on Diabetic Nephropathy**

Veronica Livetsky

Faculty Mentor: Professor Muhammad Zia

BIO-27**The Implication of INO80 Acetylation in Transcriptional Activation**

Mary Butler, Nada Nasr, Angelina Colamarino

Faculty Mentor: Professor Chang-Hui Shen

BIO-28**Effect Of Expressing PH-Tau On TDP-43, And Neurotransmitters Receptors In Mouse Neuronal**

Genesis Castro

Faculty Mentor: Professor Alejandra Alonso

BIO-29**Microbiome Influence The Memory Formation Through Gut Brain Axis**

Asisat Muritala

Faculty Mentor: Professor Faiza Peetz

BIO-30**Psychological Impacts of Intimate Partner Violence in Hispanic Communities**

Shannon Farnum

Faculty Mentor: Professor Shiryn Sukhram

BIO-31**Drinking Patterns In Black LGBTQ+ Populations In New York City**

Selvia Rofail, Mikhail Merna,

Faculty Mentor: Professor Shiryn Sukhram

BIO-32**The Effect of Pollution on Heart Disease in Humans**

Liad Darmoni

Faculty Mentor: Professor Aris Efting

BIO-33

Pseudomonas Viability and Efflux Pump Expression in Response to TNT and 2,4-DNT

Malak Alzandani

Faculty Mentor: Professor Chang-Hui Shen

BIO-34

The Implications of the Gut Microbiome on Asthma

Bhakti Dongerkery

Faculty Mentor: Professor Faiza Peetz

BIO-35

Capricorn AI: A Multi-Output Deep Learning Framework for Tissue Classification and Cancerous Nuclei Segmentation in Digital Pathology

Moshe Newman

Faculty Mentor: Professor Jimmie Fata

BIO-36

Tracking Change: The Impact of Climate on Bird Abundance and Migration in the Coastal Northeast

Frank Pira

Faculty Mentor: Professor Shaibal Mitra

BIO-37

Using Python and Natural Language Processing to Analyze Eczema Triggers, Symptoms, and Treatments from Reddit Data

Rahman Yuldashov

Faculty Mentor: Professor Jimmie Fata

BIO-38

Exploring Age and Sex-Dependent Effects of Abnormal Tau Protein Expression in the Brain, Kidney, and Testes

Sethara Karunatilake

Faculty Mentor: Professor Alejandra Alonso

BIO-39

Investigating The Role Of Collagen Genes In Lung Cancer Tumor Microenvironments

Denise Boadi, Aliana Darmaeva,

Gabriella Grabowski, Debora

Adebowale

Faculty Mentor: Professor Nancy Liu-Sullivan

BIO-40

Investigating The Role Of Collagen Genes In Lung Cancer Tumor Microenvironments

Andrew Ngai

Faculty Mentor: Professor Muhammad Zia

CHEMISTRY

CHM-01

Molecular Dynamics Simulations Of The Structural Effects Of Histone Post-translational Modifications On The Nucleosome Core Particle

Mohammad Moussa

Faculty Mentor: Professor Sharon Loverde

CHM-02

Polymer Turmeric Nanocomposites
Preparation, and In Vitro Evaluation Of
Antibacterial

Rivindya Silva

Faculty Mentor: Professor Krishnaswami
Raja

CHM-03

Exploring the Efficacy of Turmeric-Based
Nanocomposite Gauze for Hemorrhage
Control & Wound Healing for Potential
Veterinary Applications & Market
Research Insights

Joy Nasr

Faculty Mentor: Professor Krishnaswami
Raja

CHM-04

Elucidation of the HOMO and LUMO
Energies of Benzene Derivatives

Michael Arfanis

Faculty Mentor: Professor Chwen-Yang
Shew

CHM-05

Investigating the Role of Peroxide in
Prolonged Antibacterial Activity of
Singlet Oxygen

Patrick Gerges

Faculty Mentor: Professor Alan Lyons

CHM-06

From Cell Culture to Staining: Visualizing
Glioblastoma in Mouse Brain Tissue
Using H&E

Gina Iemmiti

Faculty Mentor: Professor Probal Banerjee

CHM-07

Exploring The Use Of An Amidine Base
As A Non-covalent Catalyst of Alcohol-
carboxylic Acid Esterification Reactions

Vladislav Mego

Faculty Mentor: Professor Shi Jin

CHM-08

Preparation and Characterization of
Multi-Responsive Microgels for
Controlled Drug Release

Hadi Abbas

Faculty Mentor: Professor Shuiqin Zhou

COMPUTER SCIENCE

CSC-01

Lingo Verse

Jawad Rada

Faculty Mentor: Professor Tatiana Anderson

CSC-02

Analyzing Malware Safely: A Virtual Lab
for Cybersecurity Research

Evan Brown

Faculty Mentor: Professor Ali Mohamed

CSC-03

Explainable AI For Understanding
Cybersecurity And Algorithmic Decision-
Making Risks

Jenalyse Alarcon

Faculty Mentor: Professor Soon Chun

CSC-04

N2N FOODSHARE: Neighbor-To-Neighbor Network for Food Sharing

Abdel Mahmoud, Jack Moskowitz, Sclafani Dominick,

Faculty Mentor: Professor Soon Chun

CSC-05

Visual Cryptography In Modern Healthcare

Daniel Voyevoda

Faculty Mentor: Professor Sos Agaian

CSC-06

A Non-Contact Or Invasive Approach To Real-Time Pulse Analysis

Xia Jie Ou

Faculty Mentor: Professor Sos Agaian

CSC-07

Clustering Graph-Theoretic Algorithm Based on Random Walks and Applications to Computational Vision

Kerolos Assad, Kristen Aloysius

Faculty Mentor: Professor Louis Petingi

EDUCATIONAL STUDIES

EDD-01

Play Based Learning in Early Childhood Education

Erin Westgate

Faculty Mentor: Professor Deirdre Armitage

EDD-02

Mathematical Understanding Through Play

Fei Shu, Brianna Subasic, Julia Pietropinto

Faculty Mentor: Professor Judit Kerekes

EDD-03

Engaging Young Learners with Dice: Enhancing Number Sense through Play-Based Math Activities

Klarisa Dervishi, Adriana Desposito, Hailey Bischoff, Jamie Misiti

Faculty Mentor: Professor Judit Kerekes

ENGINEERING & ENVIRONMENTAL SCIENCE

EES-01

Digital Pill Dispenser

Eslam Hussein, Amirjon Barotov, Devonte Smart

Faculty Mentor: Professor Dimitrios Pavlidis

EES-02

Advanced Fitness Metrics Smart Barbell Attachment

Kevin Zebrowski, Paul Seif

Faculty Mentor: Professor Dimitrios Pavlidis

EES-03

Word Companion

Frank Feng, Ava Thompson, Lyubin Nikita,

Faculty Mentor: Professor Dimitrios Pavlidis

EES-04**Smart Motorcycle Helmet for Crash Detection and Emergency Response**

Dominick Truszkowski, Ermenegildo Perbibaj

Faculty Mentor: Professor Dimitrios Pavlidis

EES-05**MPPT System Integrated With A Dual Axis Solar Tracking**

Omar Soliman, Abdalla Ahmed, Ahmed Khodair

Faculty Mentor: Professor Dimitrios Pavlidis

EES-06**Enhancing Autonomy for the Visually Impaired: Integrating AI Models for an Advanced Assistant System**

Evan O'Grady, Michael Kurtis, Shalin Itty

Faculty Mentor: Professor Antoniadis Neo

EES-07**Bladeless Turbocharger**

George Kolovadis

Faculty Mentor: Professor Changmin Kim

EES-08**Automated Bar Mixing Tin**

Abigail Brown, Joseph Loughran, Jason Yeung

Faculty Mentor: Professor Alfred Levin

EES-09**Pet Feeder**

Mario Takle, Albert Santiago

Faculty Mentor: Professor Dimitrios Pavlidis

EES-10**Measuring Bit Error Rate in Plastic Fiber Optics Under Bending Conditions**

Alicia Vidal, Philip Nicotra, Jade Carranza

Faculty Mentor: Professor Antoniadis Neo

EES-11**Relating Sea Surface Temperature to Coral Abundance In Florida**

Iris Ditre

Faculty Mentor: Professor Sean Thatcher

EES-12**Vital Tracker**

Mehroz Ahmed, Hassan Ahmad

Faculty Mentor: Professor Dimitrios Pavlidis

EES-13**PID Controlled Crosswind Stabilization System**

Muhammad Talha, Guxim Marke

Faculty Mentor: Professor Dimitrios Pavlidis

EES-14**Language Barrier Device**

William Davis, Nicole Mika

Faculty Mentor: Professor Dimitrios Pavlidis

EES-15**Staten Island Beach****Morphodynamics and Sediment Distribution**

Jasmine Brancati

Faculty Mentor: Professor Jane Alexander

EES-16**Solar Panels Atop CSI**

Jason Weng

Faculty Mentor: Professor Sean Thatcher

EES-17**Effects of Microplastic on Agricultural Plant Growth: Analysis of Root and Shoot Biomass Condition on Wheat (*Triticum* sp.) and Radish (*Raphanus* sp.) Species**

Taniyah Fraser

Faculty Mentor: Professor Jane Alexander

EES-18**Mapping Trees on The North Side of CSI Campus**

John Dolinar

Faculty Mentor: Professor Sean Thatcher

EES-19**Analyzing Sea Level Rise on Staten Island**

Jay Tobon

Faculty Mentor: Professor Sean Thatcher

EES-20**Ball & Beam Balance System**

Richard Zborovski, Henry Yang

Faculty Mentor: Professor Dimitrios Pavlidis

EES-21**Hazardous Slope Angles on Staten Island Analyzed Through ArcGIS Pro**

Caitlin Howard

Faculty Mentor: Professor Sean Thatcher

EES-22**How Does Spinal Cord Injury Affect Bone Mechanical Properties Of Mice Femurs?**

Lawrence Goldfeld

Faculty Mentor: Professor Jean-Philippe Berteau

EES-23**Land Coverage Changes and Impacts in Southern Colombia**

Nicole Fonseca

Faculty Mentor: Professor Sean Thatcher

EES-24**Exploration and Analysis of The John Kolic Collection from Sterling Hill Mining Museum**

Narciso Morales

Faculty Mentor: Professor Christine Bruno

EES-25

Gesture-Controlled Temperature
Adaptive Fan

George Alkhoury, Saif Al maflahy

Faculty Mentor: Professor Dimitrios
Pavlidis

EES-26

Solar Powered Mobile Charging Station

Michael Pipins, Sebastian Skalny

Faculty Mentor: Professor Jessica
Jiang

EES-27

RC Boat-Based Fish Finding and
Attraction

Philip Nicotra

Faculty Mentor: Professor Dimitrios
Pavlidis

EES-28

Food Spoilage Detector

Uran Jakupi, Josh Allen-Trayvilla

Faculty Mentor: Professor Dimitrios
Pavlidis

EES-29

Mobile Camera

Guxim Marke, Amro Ahmed

Faculty Mentor: Professor Jessica
Jiang

EES-30

A Geospatial Approach to Analyzing the
2025 Palisade Wildfire in California

Dunya Jadallah

Faculty Mentor: Professor Sean Thatcher

EES-31

OFDM Based Image Transmission
through Plastic Optical Fibers for Low
Rate Internet of Things Applications

Jade Carranza, Shalin Itty

Faculty Mentor: Professor Antoniades
Neo

ENGLISH

ENG-01

Have You Ever Thought About The Second
Person?

Gianna Liantonio

Faculty Mentor: Professor Cate Marvin

ENG-02

From Page to Practice: The Evolution of Peer
Tutoring and Writing Center Pedagogy

Sarah Ahmed

Faculty Mentor: Professor Melanie McNulty

ENG-03

Hands Off My Thoughts: How Non-Directive
Tutoring Can Foster Independent Ideas from
Students

Amanda Musto

Faculty Mentor: Professor Melanie McNulty

ENG-04

Speaker Adjustments to English Voiceless
Stop Consonants

Nora Nesimi, Ashley Wallace, Anna
Bochneva, Valentina Campanella, Iva
Ivasiuk

Faculty Mentor: Professor Jason Bishop

ENG-05

A Review Of Prosody In Autism Spectrum Disorder

Kayla Poggi

Faculty Mentor: Professor Jason Bishop

ENG-06

Are Prosodic Phrase Length And Speech Planning Related?

Daniel Manderson, Taylor Bueno

Faculty Mentor: Professor Jason Bishop

HISTORY

HST-01

America's Forgotten Dutch Colony: New Perspectives on the Colony of New Netherland

Luan Draga

Faculty Mentor: Professor John Dixon

HST-02

The Instability of Traditional Gender Roles During World War I

Valentina Schembri

Faculty Mentor: Professor Alexander Zevin

HST-03

The Advancements of Women in the Workplace from the Early 2000's-2024

Allura Surat

Faculty Mentor: Professor Susan Smith-Peter

HPCC

HPCC-01

Management and Analytics for HPCC

Allen Zhao

Faculty Mentor: Professor Alexander Tzanov

MANAGEMENT

MGT-01

The Influence and Impact on How Social Media Shapes Societies

Chloe Matuszewicz

Faculty Mentor: Professor Robert Allen

MGT-02

Understanding the Impact of Emotional Intelligence in Managing Mental Health in the Workplace

Emily Albano

Faculty Mentor: Professor Lauren Mullins

MARKETING

MKT-01

Sustainable Marketing: A case of Staten Island Small Business, Krill Arctic Foods

Naya Awai

Faculty Mentor: Professor Dan Zhang

MKT-02

**From Greenwashing to Green Leadership:
Leveraging Authentic Sustainability
Marketing In the Beauty Industry**

Diamond Jackson

Faculty Mentor: Professor Dan Zhang

MKT-03

**Color Psychology in the Context of
Advertising**

Mariam Ibrahim

Faculty Mentor: Professor Dan Zhang

MATHEMATICS

MTH-01

**Engaging Young Learners With Dice And
Unifix: Strengthening Addition Skills
Through Hands On Learning**

Vincenza Milito, Maria Vazquez,
Vanesa Gashi, Fatmira Glavatovic

Faculty Mentor: Professor Judit
Kerekes

MTH-02

**Topology and its Application to
Geographic Information Systems (GIS)**

SeungKeun Song

Faculty Mentor: Professor Abhijit
Champanerkar

MTH-03

Cube Town

Wendy Naiomy Estudillo Rodriguez,
Michelle Rammairone, Madison
Agosto, Alyssa Padilla

Faculty Mentor: Professor Judit
Kerekes

MTH-04

Roll and Hop Game

Manal Hicham, Xenia Reanda, Gina
Scaramella, Dinesha Sibera

Faculty Mentor: Professor Judit
Kerekes

MTH-05

**A Climatological Comparative Study of
Data-Driven Methods**

Megan R Trapanese

Faculty Mentor: Professor Andrew C Poje

MEDIA CULTURE

MC-01

Mpox Misinformation in the X Era

Brandon Flores

Faculty Mentor: Professor Emma Johnson

MC-02

OCD

Dominic Rosalia

Faculty Mentor: Professor Valerie Tevere

MC-03

Infinite Scrapbook

Jeonghyeon Choi

Faculty Mentor: Professor Michael Mandiberg

MC-04

Bill and His Virtual Coworker

Jeonghyeon Choi

Faculty Mentor: Professor Valerie Tevere

MC-05

Looking Out

Karen Dalton

Faculty Mentor: Professor Valerie Tevere

MC-06

The Cultural Impact of The Rock vs. John

Cena: Audience Demographics and Revenue Analysis of Wrestle Mania 28

Dennis Krumer

Faculty Mentor: Professor Tara Mateik

MC-07

Look Back at It!

Teresa Juarez-Moran

Faculty Mentor: Professor Valerie Tevere

MC-08

Movie Posters for Films Yet to Be: A Series

Max Fleischman

Faculty Mentor: Professor Valerie Tevere

MC-09

Genres

Matthew Clerville

Faculty Mentor: Professor Valerie Tevere

MC-10

Roaring into the Future: A 1920s-Inspired Academic Showcase

Algenis Reyes

Faculty Mentor: Professor Valerie Tevere

MC-11

Carl's records

Stephanie Ragano

Faculty Mentor: Professor Valerie Tevere

MC-12

T-Lab Website Demo

John Marotta

Faculty Mentor: Professor Valerie Tevere

MC-13

Attention Parents: Martial Arts Will Help Save And Improve Your Child's Life

Julius Whetstone

Faculty Mentor: Professor Valerie Tevere

MC-14

Perspective

James Dicristo

Faculty Mentor: Professor Valerie Tevere

MC-15

The Future Is Unexpected

Andrew Chang

Faculty Mentor: Professor Valerie Tevere

MC-16

El Museo

Daniel Rivera-Salazar

Faculty Mentor: Professor Valerie Tevere

MC-18

The State Of Transportation To CSI In Fall 2024

Daniel Rivera-Salazar, Bandon Flores, James Dicristo, Ryan Irizarry

Faculty Mentor: Professor Emma Johnson

NURSING

NRS-01

The Lived Experiences of Nurses Caring for Dying Intensive Care Patients

Jacob Ladin

Faculty Mentor: Professor Danna Curcio

NRS-02

Barriers to Providing Oral Care in Ventilated Patients

David Poggioli

Faculty Mentor: Professor Danielle Hunton

NRS-03

Impact of Night Shift on the Mental Health of Nurses

Melanie Akilova

Faculty Mentor: Professor Danielle Hunton

PERFORMIING & CREATIVE ARTS

PCA-01

Stereo On Canvas

Timothy Golubowski

Faculty Mentor: Professor Isidore Ramkissoon

PCA-02

The Unifying Power of Music: A Case Study of Israel

Hana Elbassiony

Faculty Mentor: Professor William Bauer

PCA-03

Music As A Tool For Coping and Building Community During Times Of Crisis: West Asia - A Case Study

Madisen Cutler

Faculty Mentor: Professor William Bauer

PHYSICAL THERAPY

PHT-01

Hip Range of Motion and Strength as a Determinant of Floor to Stand Movement Patterns

Michael Kehoe

Faculty Mentor: Professor Amanda Rotondo

PHYSICS & ASTRONOMY

PHY/AST-01

Initial Morphology for E+A Galaxies in the Sloan Digital Sky Survey

Jacob Yuzovitskiy

Faculty Mentor: Professor Charles Liu

POLITICAL SCIENCE & GLOBAL AFFAIRS

PSGA-01

The 13th Amendment and Intentional Systemic Racism through the US Legal System

Giselle Vargas

Faculty Mentor: Professor Halil Ozen

PSYCHOLOGY

PSY-01

Responses to Direct Eye Contact in Preschool-Aged Children Varying in Autistic Traits Function

Alexis Lambertson

Faculty Mentor: Professor Jennifer Wagner

PSY-02

Effect of Identity and Mental Health Factors on the Accuracy of Eyewitness Testimony

Nicolas Moncada, Ezra Schilling, James Trachuk

Faculty Mentor: Professor Dawson

Dufort

PSY-03

The Impact of Vision Impairment on Development and Daily Life in Young Adults and Children Exploration

Merna Mikhail

Faculty Mentor: Professor Louis Rotondo

PSY-04

Cortisol Awakening Response (CAR) And Its Relation To Behaviors Characteristic Of ASD In Adults

Elizabeth Obadimu

Faculty Mentor: Professor Lana Karasik

PSY-05

The Effects of Chronic Social Isolation on Oligodendrocyte Progenitor Cells in the Anterior Corpus Callosum

Gianna Albano

Faculty Mentor: Professor Leora Yetnikoff

PSY-06

Studying Infant Temperament in Tajikistan

Nickolay Munoz

Faculty Mentor: Professor Lana Karasik

PSY-07

Using Six Thinking Hats to Combine Diverse Perspectives in Peer-Led Team Lear

Jacky Zhao

Faculty Mentor: Professor Daniel McCloskey

PSY-08

The Role of Serotonin 1A Receptors in Neurogenesis in Neonatal Mouse Hippocampus via PKC Mediated Signaling

Deena Mohsen

Faculty Mentor: Professor Probal Banerjee

PSY-09

How We Feel In Relation To Where We Live

Eric Hernandez

Faculty Mentor: Professor Kristen Gillespie-Lynch

PSY-10

Inferiority Complex vs. Superiority Complex: Is This the Reason for Your Underlying Job Satisfaction?

Angelina Fattorusso, Laura Lopez, Emmanuel Gonzalez

Faculty Mentor: Professor Kristen Gillespie-Lynch

PSY-11

Physical Therapists' & Caregivers' Role in Early Intervention

Jenna Como

Faculty Mentor: Professor Sarah Berger

PSY-12

Automated, Low-Cost CO₂ Sensing for Real-Time Monitoring of High-CO₂ Naked Mole-Rat Environments

Edward Leibowitz

Faculty Mentor: Professor Dan McCloskey

PSY-13

Cross-Cultural Comparison of Focused Attention in Infants from Tajikistan and the United States

Abrar Alzandani

Faculty Mentor: Professor Sarah Berger

PSY-14

The Effects of Chronic Social Isolation During Adulthood on Dopamine Axon Terminal Density in the Anterior Corpus Callosum

Colin Alarcon

Faculty Mentor: Professor Leora Yetnikoff

PSY-15

The Relationship Between Peer Connectedness and Team Performance among Introductory Psychology Students in a Peer Enhanced Blockchain Based Learning Environment (PEBBLE)

Colin Alarcon

Faculty Mentor: Professor Dan McCloskey

PSY-16

Analyzing Feedback from Autistic Mentors and Mentees in the Making Mentors Program

Kenny Velez, Lela Fluker, Victoria Desantis

Faculty Mentor: Professor Kristen Gillespie-Lynch

PSY-17

Breastfeeding in Context: Effects of Gahvora Cradling in Tajikistan

Christopher Hadchity

Faculty Mentor: Professor Kristen Gillespie-Lynch

PSY-18

The Persistence of Theory of Mind and Language Ability in Adulthood

Jacob Keeton

Faculty Mentor: Professor Patricia Brooks

PSY-19

Multi-modal Learning Information In Autistic Students With And Without ADHD

Madisen Cutler

Faculty Mentor: Professor Kristen Gillespie-Lynch

PSY-20

Neuropeptide-Y and Stress Regulation in Naked Mole-Rats: Investigating Subgroup Differences in Receptor Density

Stephanie Tirado

Faculty Mentor: Professor Dan McCloskey

PSY-21**Do College Students Who Live On Their Own Seek Out Mental Health Support More Than College Students Who Still Live With Their Family?**

Jade Huie, Alban Shaquiri, Jacky Zhao

Faculty Mentor: Professor Kristen Gillespie-Lynch

PSY-22**Ethologically-Relevant Naked Mole Rat Habitat**

Lillian Diaz

Faculty Mentor: Professor Dan McCloskey

PSY-23**The Impact of Seasonality on Infant Motor Development**

Lia Ohana

Faculty Mentor: Professor Sarah Berger

PSY-24**Effects of an Autism-Focused Sabbatical Program Taught by Autistic Educators on Teaching Perspectives**

Laila Balogun, Shallyrose Lorenzo

Faculty Mentor: Professor Kristen Gillespie-Lynch

PSY-25**Stroop Task and Language Experience: A Comparison of Bilingual and Monolingual Response Times**

Kaylah Amuquandoh

Faculty Mentor: Professor Natalie Batman

PSY-26**From Touch to Movement: Exploring Infant Self-Directed Touch and Motor Development**

Maleeha Khan

Faculty Mentor: Professor Sarah Berger

PSY-28**Investigating the Impact of Social Isolation in Adolescents in the Corpus Callosum**

Lara Rizkalla

Faculty Mentor: Professor Leora Yetnikoff

PSY-29**Understanding the great political divide: A look at the psychological underpinnings of the 2024 Presidential Election**

Marc Mendez

Faculty Mentor: Professor Florette Cohen

PSY-230**The Relationship Between Infant Posture and Toy Exploration in PT Sessions**

Jordan Swanson

Faculty Mentor: Professor Sarah Berger

A lightbulb with a network diagram inside it. The network consists of several large blue circles connected by lines, with many smaller circles branching off from them. The lightbulb is blue and has a screw-in base.

APPENDIX

STUDENT	FACULTY MENTOR	DEPARTMENT	POSTER ID
Hadi Abbas	Shuiqin Zhou	Chemistry	CHEM - 08
Menatalla Aboukhalia	Faiza Peetz	Biology	BIO - 12
Debora Adebowale	Nancy Liu-Sullivan	Biology	BIO - 39
Madison Agosto	Judit Kerekes	Mathematics	MTH - 03
Hassan Ahmad	Dimitrios Pavlidis	Eng & Env Sci	EES - 12
Sarah Ahmed	Melanie McNulty	English	ENG - 02
Mehroz Ahmed	Dimitrios Pavlidis	Eng & Env Sci	EES - 12
Abdalla Ahmed	Dimitrios Pavlidis	Eng & Env Sci	EES - 05
Amro Ahmed	Jessica Jiang	Eng & Env Sci	EES - 29
Melanie Akilova	Danielle Hunton	Nursing	NRS - 03
David Akodu	Nancy Liu-Sullivan	Biology	BIO - 10
Saif Al maflahy	Dimitrios Pavlidis	Eng & Env Sci	EES - 25
Jenalyse Alarcon	Soon Chun	Computer Science	CSC - 03
Colin Alarcon	Leora Yetnikoff	Psychology	PSY - 14
Emily Albano	Lauren Mullins	Management	MGT - 02
Gianna Albano	Leora Yetnikoff	Psychology	PSY - 05
George Alkhoury	Dimitrios Pavlidis	Eng & Env Sci	EES - 25
Malak Alkiswani	Aris Efting	Biology	BIO - 25
Josh Allen-Trayvilla	Dimitrios Pavlidis	Eng & Env Sci	EES - 28
Kristen Aloysius	Louis Petingi	Computer Science	CSC - 07
Ambar Alvarenga	Nancy Liu-Sullivan	Biology	BIO - 04
Malak Alzandani	Chang-Hui Shen	Biology	BIO - 33
Abrar Alzandani	Sarah Berger	Psychology	PSY - 13
Kaylah Amuquandoh	Natalie Batman	Psychology	PSY - 25
Michael Arfanis	Chwen-Yang Shew	Chemistry	CHEM - 04
Kerolos Assad	Louis Petingi	Computer Science	CSC - 07
Naya Awai	Dan Zhang	Marketing	MKT - 01
Mariam Ayed	Esposito Michelle	Biology	BIO - 17
Laila Balogun	Kristen Gillespie-Lynch	Psychology	PSY - 24
Amirjon Barotov	Dimitrios Pavlidis	Eng & Env Sci	EES - 01
Hailey Bischoff	Judit Kerekes	Educational Studies	EDD - 03
Denise Boadi	Nancy Liu-Sullivan	Biology	BIO - 39
Anna Bochner	Jason Bishop	English	ENG - 04

STUDENT	FACULTY MENTOR	DEPARTMENT	POSTER ID
Jasmine Brancati	Jane Alexander	Eng & Env Sci	EES - 15
Abigail Brown	Alfred Levine	Eng & Env Sci	EES - 08
Evan Brown	Ali Mohamed	Computer Science	CSC - 02
Taylor Bueno	Jason Bishop	English	ENG - 06
Mary Butler	Chang-Hui Shen	Biology	BIO - 27
Valentina Campanella	Jason Bishop	English	ENG - 04
Jade Carranza	Neo Antoniades	Eng & Env Sci	EES - 31
Genesis Castro	Alejandra Alonso	Biology	BIO - 28
Andrew Chang	Valerie Tevare	Media Culture	MC - 15
Jeonghyeon Choi	Michael Mandiberg	Media Culture	MC - 03
Jeonghyeon Choi	Valerie Tevere	Media Culture	MC - 04
Matthew Clerville	Valerie Tevere	Media Culture	MC - 09
Angelina Colamarino	Chang-Hui Shen	Biology	BIO - 27
Jenna Como	Sarah Berger	Psychology	PSY - 11
Madisen Cutler	William Bauer	Performing and Creative Arts	PCA - 03
Karen Dalton	Valerie Tevere	Media Culture	MC - 05
Rivera-Salazar Daniel	Tevere Valarie	Media Culture	MC - 16
Jawuneh Danmbisaa	Cesar Arenas-Mena	Biology	BIO - 23
Aliana Darmaeva	Nancy Liu-Sullivan	Biology	BIO - 39
Liad Darmoni	Aris Efting	Biology	BIO - 32
William Davis	Dimitrios Pavlidis	Eng & Env Sci	EES - 14
Branny De Jesus Santana	Faiza Peetz	Biology	BIO - 13
Klarisa Dervishi	Judit Kerekes	Educational Studies	EDD - 03
Victoria Desantis	Kristen Gillespie-Lynch	Psychology	PSY - 16
Shane Desilva	Shiryn Sukhram	Biology	BIO - 24
Adriana Desposito	Judit Kerekes	Educational Studies	EDD - 03
Lillian Diaz	Daniel McCloskey	Psychology	PSY - 22
James Dicristo	Valerie Tevere	Media Culture	MC - 14
Iris Ditre	Sean Thatcher	Eng & Env Sci	EES - 11
John Dolinar	Thatcher Sean	Eng & Env Sci	EES - 18
Sclafani Dominick	Soon Chun	Computer Science	CSC - 04
Bhakti Dongerkery	Faiza Peetz	Biology	BIO - 34
Luan Draga	John Dixon	History	HST - 01
Hana Elbassiony	William Bauer	Performing and Creative Arts	PCA - 02

STUDENT	FACULTY MENTOR	DEPARTMENT	POSTER ID
Nourhan Elzayat	Aris Efting	Biology	BIO - 18
Wendy Naiomy Estudillo Rodriguez	Judit Kerekes	Mathematics	MTH - 03
Shannon Farnum	Shiryn Sukhram	Biology	BIO - 30
Angelina Fattorusso	Kristen Gillespie-Lynch	Psychology	PSY - 10
Frank Feng	Dimitrios Pavlidis	Eng & Env Sci	EES - 03
Lauren Ferguson	Greg Phillips	Biology	BIO - 20
Nicholas Finkel	Simone Wegge	Economics	ECON - 01
Max Fleischman	Valerie Tevere	Media Culture	MC - 08
Brandon Flores	Emma Johnson	Media Culture	MC - 01
Lela Fluker	Kristen Gillespie-Lynch	Psychology	PSY - 16
Nicole Fonseca	Sean Thatcher	Eng & Env Sci	EES - 23
Taniyah Fraser	Jane Alexander	Eng & Env Sci	EES - 17
Vanesa Gashi	Judit Kerekes	Mathematics	MTH - 01
Patrick Gerges	Alan Lyons	Chemistry	CHEM - 05
Fatmira Glavatovic	Judit Kerekes	Mathematics	MTH - 01
Lawrence Goldfeld	Jean-Philippe Berteau	Eng & Env Sci	EES - 22
Timothy Golubowski	Isidore Ramkissoon	Performing and Creative Arts	PCA - 01
Emmanuel Gonzalez	Kristen Gillespie-Lynch	Psychology	PSY - 10
Gabriella Grabowski	Nancy Liu-Sullivan	Biology	BIO - 39
Christopher Hadchity	Kristen Gillespie-Lynch	Psychology	PSY - 17
Santos Hana	Nancy Liu-Sullivan	Biology	BIO - 10
Samer Hana	Nancy Liu-Sullivan	Biology	BIO - 10
Eric Hernandez	Kristen Gillespie-Lynch	Psychology	PSY - 09
Manal Hicham	Judit Kerekes	Mathematics	MTH - 04
Caitlin Howard	Sean Thatcher	Eng & Env Sci	EES - 21
Ethan Hoy	Muhammad Zia	Biology	BIO - 11
Jade Huie	Kristen Gillespie-Lynch	Psychology	PSY - 21
Eslam Hussein	Dimitrios Pavlidis	Eng & Env Sci	EES - 01
Mariam Ibrahim	Dan Zhang	Marketing	MKT - 03
Gina Iemmiti	Probal Banerjee	Chemistry	CHEM - 06
Poornima Ilangachcharige	Shiryn Sukhram	Biology	BIO - 24
Ryan Irizarry	Emma Johnson	Media Culture	MC - 18

STUDENT	FACULTY MENTOR	DEPARTMENT	POSTER ID
Shalin Itty	Neo Antoniades	Eng & Env Sci	EES - 31
Iva Ivasiuk	Jason Bishop	English	ENG - 04
Diamond Jackson	Dan Zhang	Marketing	MKT - 02
Dunya Jadallah	Sean Thatcher	Eng & Env Sci	EES - 30
Uran Jakupi	Dimitrios Pavlidis	Eng & Env Sci	EES - 28
Teresa Juarez-Moran	Valerie Tevere	Media Culture	MC - 07
Kalinowski Julia	Esposito Michelle	Biology	BIO - 17
Julia Kalinowski	Michelle Esposito	Biology	BIO - 01
Sethara Karunatilake	Alejandra Alonso	Biology	BIO - 38
Jacob Keeton	Patricia Brooks	Psychology	PSY - 18
Michael Kehoe	Amanda Rotondo	Physical Therapy	PHT - 01
Brian Kerliu	Lisa Manne	Biology	BIO - 21
Maleeha Khan	Sarah Berger	Psychology	PSY - 26
Ahmed Khodair	Dimitrios Pavlidis	Eng & Env Sci	EES - 05
George Kolovadis	Changmin Kim	Eng & Env Sci	EES - 07
Dennis Krumer	Tara Mateik	Media Culture	MC - 06
Bora Kupa	Krishnaswami Raja	Biology	BIO - 22
Michael Kurtis	Neo Antoniades	Eng & Env Sci	EES - 06
Jacob Ladin	Danna Curcio	Nursing	NRS -01
Alexis Lambertson	Jennifer Wagner	Psychology	PSY - 01
Sarah Lebaili	Nancy Liu-Sullivan	Biology	BIO - 10
Jacob Lebedinsky	Nancy Liu-Sullivan	Biology	BIO - 10
Edward Leibowitz	Dan McCloskey	Psychology	PSY - 12
Gianna Liantonio	Cate Marvin	English	ENG - 01
Veronica Livetsky	Muhammad Zia	Biology	BIO - 26
Laura Lopez	Kristen Gillespie-Lynch	Psychology	PSY - 10
Shallyrose Lorenzo	Kristen Gillespie-Lynch	Psychology	PSY - 24
Joseph Loughran	Alfred Levine	Eng & Env Sci	EES - 08
Abdel Mahmoud	Soon Chun	Computer Science	CSC - 04
Haneen Makii	Nancy Liu-Sullivan	Biology	BIO - 10
Daniel Manderson	Jason Bishop	English	ENG - 06
Guxim Marke	Jessica Jiang	Eng & Env Sci	EES - 29
John Marotta	Valerie Tevere	Media Culture	MC - 12
Chloe Matuszewicz	Robert Allen	Management	MGT - 01
Vladislav Mego	Shi Jin	Chemistry	CHEM - 07
Marc Mendez	Florette Cohen	Psychology	PSY - 29

STUDENT	FACULTY MENTOR	DEPARTMENT	POSTER ID
Mikhail Merna	Shiryn Sukhram	Biology	BIO - 31
Sue-Allen Mettry	Faiza Peetz	Biology	BIO - 05
Nicole Mika	Dimitrios Pavlidis	Eng & Env Sci	EES - 14
Merna Mikhail	Louis Rotondo	Psychology	PSY - 03
Vincenza Milito	Judit Kerekes	Mathematics	MTH - 01
Jamie Misiti	Judit Kerekes	Educational Studies	EDD - 03
Deena Mohsen	Probal Banerjee	Psychology	PSY - 08
Nicolas Moncada	Dawson Dufort	Psychology	PSY - 02
Narciso Morales	Christine Bruno	Eng & Env Sci	EES - 24
Jack Moskowitz	Soon Chun	Computer Science	CSC - 04
Mohammad Moussa	Sharon Loverde	Chemistry	CHEM - 01
Ilyana Mukabenova	Nancy Liu-Sullivan	Biology	BIO - 16
Nickolay Munoz	Lana Karasik	Psychology	PSY - 06
Asisat Muritala	Faiza Peetz	Biology	BIO - 29
Amanda Musto	Melanie McNulty	English	ENG - 03
Andrew Ngai	Muhammad Zia	Biology	BIO - 40
Joy Nasr	Krishnaswami Raja	Chemistry	CHEM - 03
Nada Nasr	Chang-Hui Shen	Biology	BIO - 27
Nora Nesimi	Jason Bishop	English	ENG - 04
Moshe Newman	Jimmie Fata	Biology	BIO - 35
Philip Nicotra	Dimitrios Pavlidis	Eng & Env Sci	EES - 27
Philip Nicotra	Neo Antoniades	Eng & Env Sci	EES - 10
Lyubin Nikita	Dimitrios Pavlidis	Eng & Env Sci	EES - 03
Morgan Novello	Lisa Manne	Biology	BIO - 19
Elizabeth Obadimu	Lana Karasik	Psychology	PSY - 04
Evan O'Grady	Antoniades Neo	Eng & Env Sci	EES - 06
Hiqmat Ogunsanya	Nancy Liu-Sullivan	Biology	BIO - 16
Tal Ohana	Jonathan Peters	Accounting and Finance	ACC/FNC - 02
Lia Ohana	Sarah Berger	Psychology	PSY - 23
Xia Jle Ou	Sos Agaian	Computer Science	CSC - 06
Miguel Andrei padilla	Shiryn Sukhram	Biology	BIO - 24
Alyssa Padilla	Judit Kerekes	Mathematics	MTH - 03
Julia Palka	Faiza Peetz	Biology	BIO - 08
Sanaia Parker-Bey	Tara Mateik	Media Culture	MC - 17

STUDENT	FACULTY MENTOR	DEPARTMENT	POSTER ID
Ermenegildo Perbibaj	Dimitrios Pavlidis	Eng & Env Sci	EES - 04
Fatima Perera	Patricia Galletta	Accounting and Finance	ACC/FNC - 05
Julia Pietropinto	Judit Kerekes	Educational Studies	EDD - 02
Michael Pipins	Jessica Jiang	Eng & Env Sci	EES - 26
Frank Pira	Shaibal Mitra	Biology	BIO - 36
Kayla Poggi	Jason Bishop	English	ENG - 05
David Poggioli	Danielle Hunton	Nursing	NRS - 02
Jessica Poplawski	Jean-Phillippe Berteau	Biology	BIO - 03
Jawad Rada	Tatiana Anderson	Computer Science	CSC - 01
Stephanie Ragano	Valerie Tevere	Media Culture	MC - 11
Michelle Rammairone	Judit Kerekes	Mathematics	MTH - 03
Xenia Reanda	Judit Kerekes	Mathematics	MTH - 04
Algenis Reyes	Valerie Tevere	Media Culture	MC - 10
Mir Rhaman	Faiza Peetz	Biology	BIO - 07
Lara Rizkalla	Leora Yetnikoff	Psychology	PSY - 28
Selvia Rofail	Shiryn Sukhram	Biology	BIO - 31
Marcelina Rokicki	Faiza Peetz	Biology	BIO - 09
Adrian Rosales	Jonathan Peters	Accounting and Finance	ACC/FNC - 07
Dominic Rosalia	Valerie Tevere	Media Culture	MC - 02
Albert Santiago	Dimitrios Pavlidis	Eng & Env Sci	EES - 09
Gina Scaramella	Judit Kerekes	Mathematics	MTH - 04
Valentina Schembri	Alexander Zevin	History	HST - 02
Ezra Schilling	Dawson Dufort	Psychology	PSY - 02
Paul Seif	Dimitrios Pavlidis	Eng & Env Sci	EES - 02
Alban Shaquiri	Kristen Gillespie-Lynch	Psychology	PSY - 21
Fei Shu	Judit Kerekes	Educational Studies	EDD - 02
Dinesha Sibera	Judit Kerekes	Mathematics	MTH - 04
Rivindya Silva	Krishnaswami Raja	Chemistry	CHEM - 02
Sebastian Skalny	Jessica Jiang	Eng & Env Sci	EES - 26
Devonte Smart	Dimitrios Pavlidis	Eng & Env Sci	EES - 01
Omar Soliman	Dimitrios Pavlidis	Eng & Env Sci	EES - 05
Joseph Sollitto	Jonathan Peters	Accounting and Finance	ACC/FNC - 03
SeungKeun Song	Abhijit Champanerkar	Mathematics	MTH - 02
Luciano Spagnuolo	Muhammad Zia	Biology	BIO - 11
Brianna Subasic	Judit Kerekes	Educational Studies	EDD - 02

STUDENT	FACULTY MENTOR	DEPARTMENT	POSTER ID
Allura Surat	Susan Smith-Peter	History	HST - 03
Jordan Swanson	Sarah Berger	Psychology	PSY - 30
Mario Takle	Dimitrios Pavlidis	Eng & Env Sci	EES - 09
Muhammad Talha	Dimitrios Pavlidis	Eng & Env Sci	EES - 13
Ahsan Tasneem	Esposito Michelle	Biology	BIO - 17
Ava Thompson	Dimitrios Pavlidis	Eng & Env Sci	EES - 03
Stephanie Tirado	Dan McCloskey	Psychology	PSY - 20
Jay Tobon	Sean Thatcher	Eng & Env Sci	EES - 19
James Trachuk	Dawson Dufort	Psychology	PSY - 02
Megan Trapanese	Andrew Poje	Mathematics	MTH - 05
Dominick Truskowski	Dimitrios Pavlidis	Eng & Env Sci	EES - 04
Melina Turco	Nancy Liu-Sullivan	Biology	BIO - 04
Jennifer Tuzzo	Patricia Galletta	Accounting and Finance	ACC/FNC - 04
Abedalfattah Twam	Nancy Liu-Sullivan	Biology	BIO - 02
Giselle Vargas	Halil Ozen	Poli Sci & Global Affairs	PSGA - 01
Maria Vazquez	Judit Kerekes	Mathematics	MTH - 01
Kenny Velez	Kristen Gillespie-Lynch	Psychology	PSY - 16
Richard Verdi Jr.	Aris Efting	Biology	BIO - 06
Alicia Vidal	Neo Antoniadis	Eng & Env Sci	EES - 10
Christopher Vitale	Jonathan Peters	Accounting and Finance	ACC/FNC - 01
Daniel Voyevoda	Sos Agaian	Computer Science	CSC - 05
Ashley Wallace	Jason Bishop	English	ENG - 04
Jason Weng	Sean Thatcher	Eng & Env Sci	EES - 16
Erin Westgate	Deirdre Armitage	Educational Studies	EDD - 01
Julius Whetstone	Valerie Tevere	Media Culture	MC - 13
Henry Yang	Dimitrios Pavlidis	Eng & Env Sci	EES - 20
Jason Yeung	Alfred Levine	Eng & Env Sci	EES - 08
Aisha Yousaf	Nancy Liu-Sullivan	Biology	BIO - 10
Joey Yu	Lisa Manne	Biology	BIO - 15
Huli Yu	Banu Aslanertik	Accounting and Finance	ACC/FNC - 06
Rahman Yuldashov	Jimmie Fata	Biology	BIO - 37
Jacob Yuzovitskiy	Charles Liu	Physics and Astronomy	PHY/AST - 01
Richard Zborovski	Dimitrios Pavlidis	Eng & Env Sci	EES - 20
Kevin Zebrowski	Dimitrios Pavlidis	Eng & Env Sci	EES - 02
Jacky Zhao	Daniel McCloskey	Psychology	PSY - 07
Allen Zhao	Alexander Tzanov	HPCC	HPCC - 01
Jacky Zhao	Kristen Gillespie-Lynch	Psychology	PSY - 21

MACAULAY HONORS

Jenalyse Alarcon
Colin Alarcon
Kerolos Assad
Angelina Colamarino
Jenna Como
Shannon Farnum
Frank Feng
Lauren Ferguson
Lawrence Goldfeld
Gina Lemmiti
Julia Kalinowski
Michael Kehoe
Brian Kerliu
Jacob Lebedinsky
Veronica Livetsky
Abdel Mahmoud
Nickolay Munoz
Nada Nasr
Philip Nicotra
Tal Ohana
David Poggioli
Jessica Poplawski
Adrian Rosales
Valentina Schembri
Joseph Sollitto
Luciano Spagnuolo
Ava Thompson
Stephanie Tirado
Megan Trapanese
Christopher Vitale
Joey Yu
Richard Zborovski

VERRAZZANO HONORS

Hadi Abbas
Menatalla
Aboukhalia
Melanie Akilova
Gianna Albano
Malak Alkiswani
Abrar Alzandani
Evan Brown
Liad Darmoni
Luan Draga
Patrick Gerges
Timothy Golubowski
Eslam Hussein
Mariam Ibrahim
Sethara Karunatilake
Gianna Liantonio
Haneen Makii
Chloe Matuszewicz
Merna Mikhail
Deena Mohsen
Mohammad Moussa
Moshe Newman
Morgan Novello
Lia Ohana
Miguel Andrei
Padilla
Julia Palka
Kayla Poggi
Lara Rizkalla
Selvia Rofail
Allura Surat
Dominick
Truskowski
Jennifer Tuzzo
Abedalfattah Twam
Richard Verdi Jr.
Alicia Vidal
Erin Westgate
Aisha Yousaf
Kevin Zebrowski

CUNY RESEARCH SCHOLARS

Gianna Albano
Ambar Alvarenga
Anna Bochner
Genesis Castro
Patrick Gerges
Nora Nesimi
Xia Jie Ou
Selvia Rofail
Melina Turco
Daniel Voyevoda
Ashley Wallace

CIRE SCHOLARS

Colin Alarcon
Jasmine Brancati
Lauren Ferguson
Jacob Ladin
Daniel Manderson
Joseph Sollitto

We extend our heartfelt thanks to all the student presenters for sharing their outstanding work and creativity at this year's Undergraduate Conference.

We sincerely thank the dedicated faculty mentors for their invaluable guidance and support throughout this process.

A special thank you to the Alumni Association for their generous sponsorship and continued commitment to student success.

We also thank all the volunteers whose time, energy, and effort helped bring this event to life.

Your collective contributions have made this conference a meaningful and memorable experience for our campus community.

Organizers

Laxmi Ramasubramanian & Yolelda Ira

Office of the Associate Provost for Faculty Success

College of Staten Island, 2800 Victory Boulevard, Bldg. 1A - 211

Staten Island, NY 10314

This image shows a full page of blank, lined paper. It features approximately 20 evenly spaced horizontal grey lines across its entire width, providing a guide for handwriting or typing. The paper itself is a clean, off-white color. There are no margins, text, or other markings present on the page.



Scan here for more
conference information

CC CLUE